

**89-400**  
**Continuous Thread Closure**  
**Smooth Finish**

Comet Part Number: 1340-0132

**Product Benefits**

- General Purpose closure
- FDA approved

**Closure Specifications**

- Diameter: 89mm
- Thread Profile: 400
- Neck Finish: 89-400
- Cap Height: 0.530 inches
- Closure Top: Matte
- Closure Sidewall: Smooth
- Material: PP

**Markets**

- ❖ Agricultural products
- ❖ Dressing and Sauces
- ❖ Food
- ❖ Food Services
- ❖ Industrial Applications
- ❖ Medical Products
- ❖ Cosmetics
- ❖ Pharmaceuticals

**Options**

- Available in white, black, standard colors as well as custom colors
- Custom embossing available
- Both lined and unlined options available

**Packaging and Logistics Information**

Pack Type	Pallet Dimensions	PCS/CTN	CTNS/skid	PCS/skid	Freight
Skid	48 x 44 x 86	650	24	15,600	FOB Pitman, NJ 08071

**Location:**  
651 Lambs Road, Pitman, NJ 08071

2

1

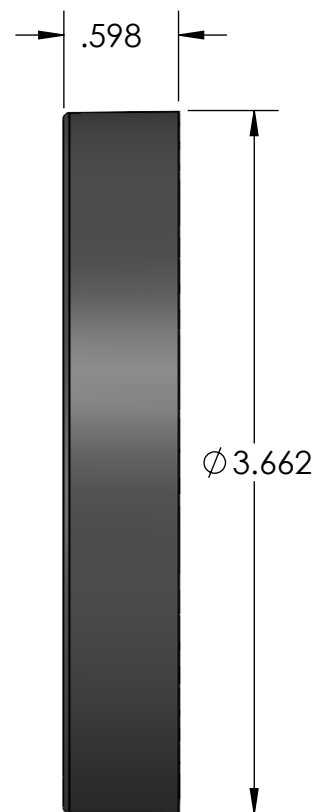
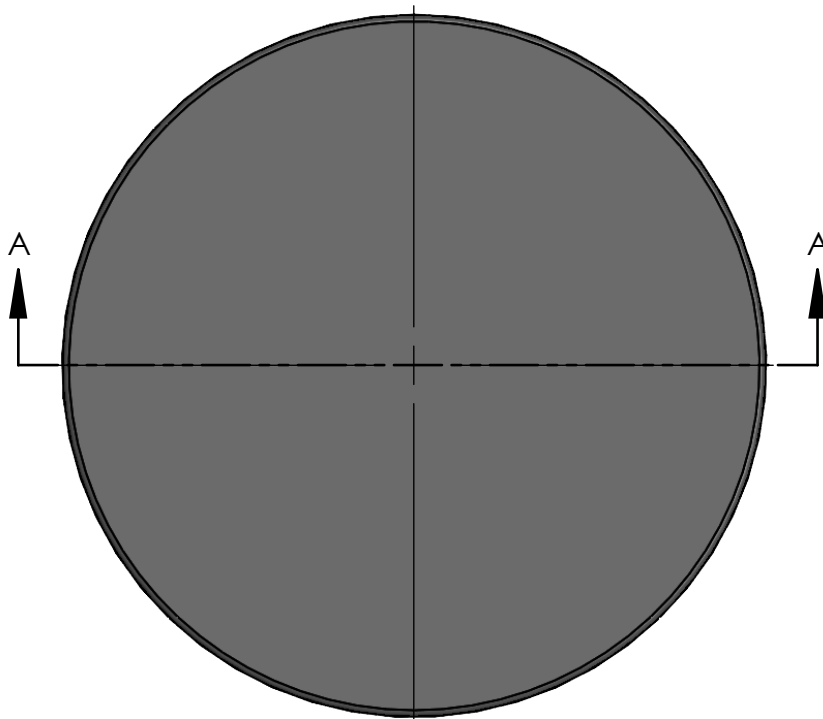

EXTERIOR SURFACES FINISHED SPI-A2 POLISH  
UNSPECIFIED INTERIOR AREAS FINISHED SPI-B2

THREAD DATA:  
89-400 FINISH  
.200 PITCH (5 TPI)  
APPROX. 1-1/8 TURNS

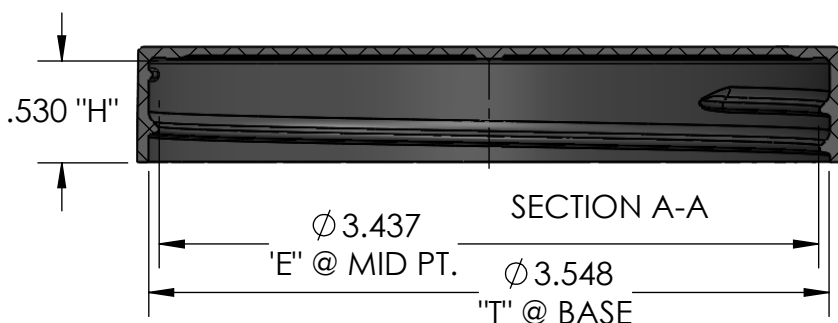

ADVERTISING DRAWING  
NOT FOR QUALITY CONTROL

<b>UNLESS OTHERWISE SPECIFIED:</b>	
DIMENSIONS ARE IN INCHES	
TOLERANCES:	
FRACTIONAL:	±1/32
ANGULAR:	±1/2
TWO PLACE DECIMAL:	±.03
THREE PLACE DECIMAL:	±.015



**COMET TOOL COMPANY**

651 LAMBS RD. PITMAN, N.J 08071-2042

TITLE:

**89-400Smooth(REV A) detail**

PROPRIETARY AND CONFIDENTIAL

MATERIAL

SHRINKAGE \*

DRAWN BY **MG**

PLASTIC PART NO. \*

PLASTIC PART REV. \*

DWG. NO. \*

SIZE **A**

REV \*

DATE

THE INFORMATION CONTAINED IN THIS DRAWING IS THE SOLE PROPERTY OF COMET TOOL COMPANY. ANY REPRODUCTION IN PART OR WHOLE WITHOUT THE WRITTEN PERMISSION OF COMET TOOL COMPANY IS PROHIBITED.

SCALE: 1:1

SHEET 1 OF 2

2

1